

AVAILABLE 7,680 SF



SEC Sepulveda Blvd. & Vanowen St., Van Nuys, CA 91405

Annika Riphagen

(562) 431-8734 x-114
ariphagen@pacret.com
DRE License #: 01734521

911 Studebaker Road
Suite 205
Long Beach, CA 90815

www.pacret.com

Creating
Real Estate
Value

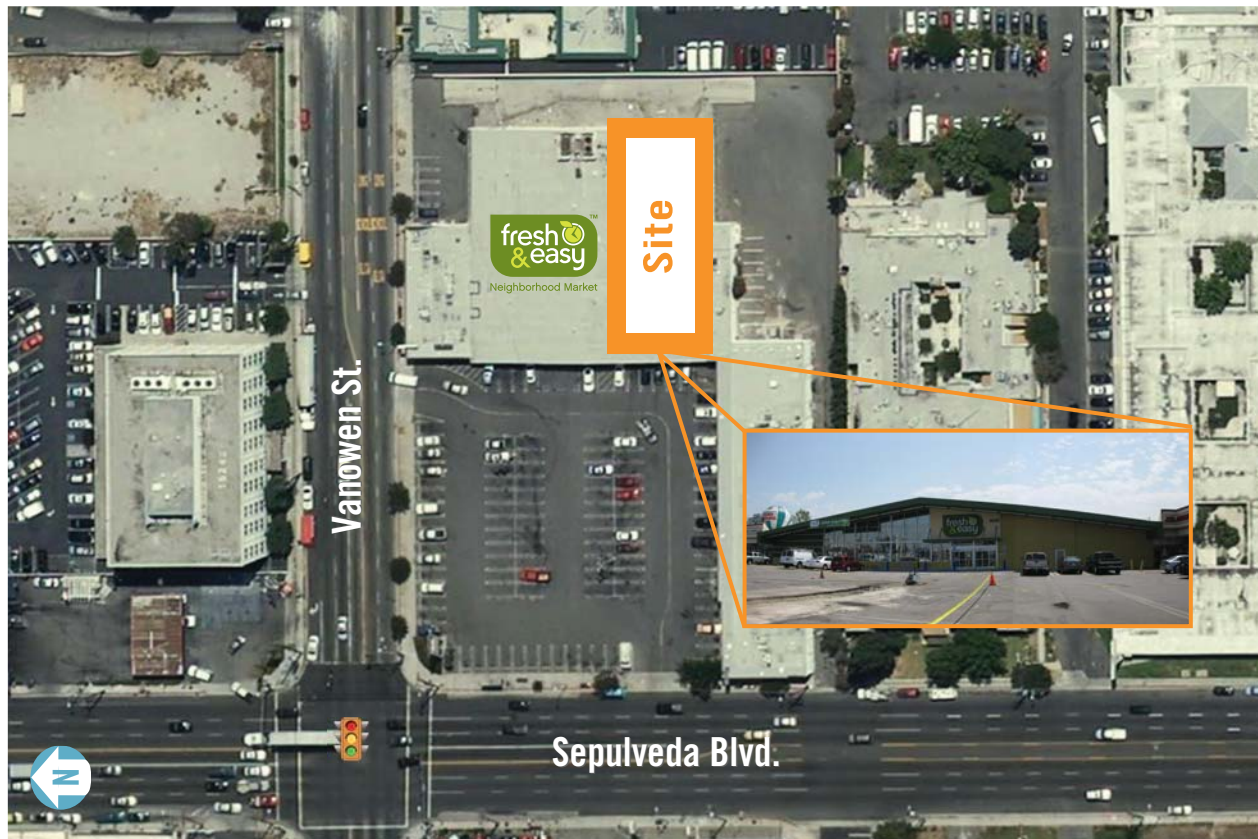

Demographics

(2010 Est.)	0.5 Mile	1 Mile	2 Mile	3 Mile
Population	11,761	45,759	130,895	291,257
Households	4,333	15,868	44,356	99,581
Avg. HH Income	\$50,741	\$47,582	\$51,627	\$61,139
Med. HH Income	\$39,351	\$35,803	\$38,531	\$42,746
Daytime Population	11,785	35,826	130,654	282,421

Traffic Counts

Sepulveda Blvd.	41,654	Source: CoStar Group Inc.
Vanowen St.	36,732	

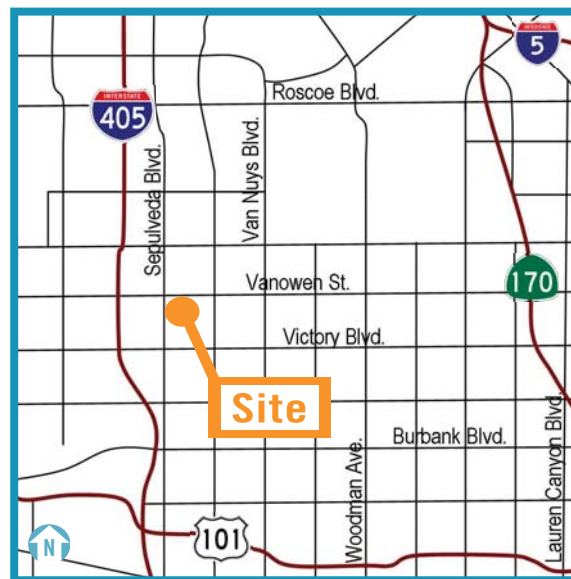

Scan with your
mobile device



The information above has been obtained from sources believed reliable. While we do not doubt its accuracy, we have not verified it and make no guarantee, warranty or representation. It is your responsibility to independently confirm its accuracy and completeness.



AVAILABLE 7,680 SF



Annika Riphagen

(562) 431-8734 x-114
ariphagen@pacret.com
DRE License #: 01734521

911 Studebaker Road
Suite 205
Long Beach, CA 90815

www.pacret.com

Creating
Real Estate
Value

SEC Sepulveda Blvd. & Vanowen St., Van Nuys, CA 91405

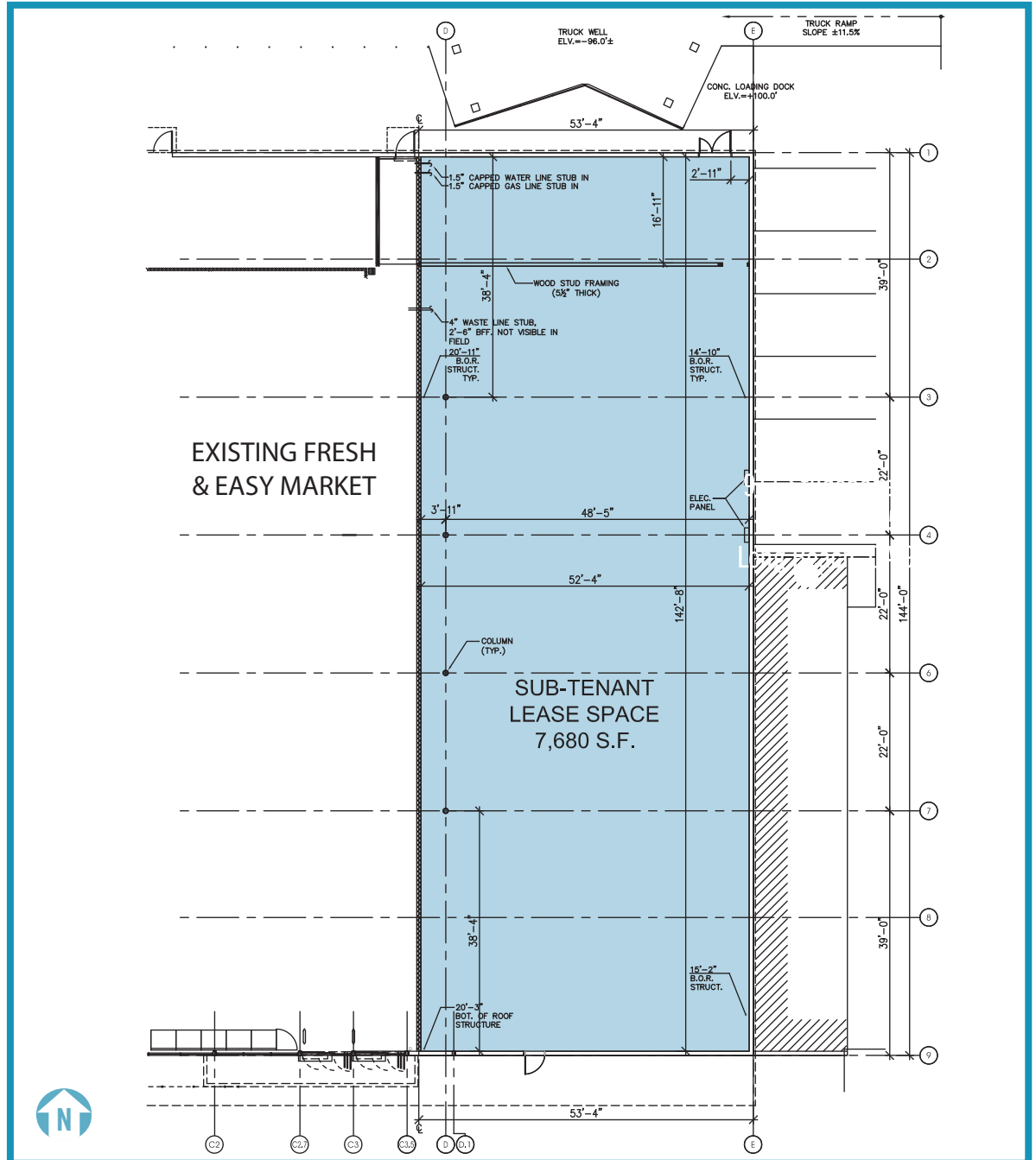

Property Highlights

- Across the street from Valley Presbyterian Hospital
- In close proximity to the 405 Freeway

The information above has been obtained from sources believed reliable. While we do not doubt its accuracy, we have not verified it and make no guarantee, warranty or representation. It is your responsibility to independently confirm its accuracy and completeness.

