

AVAILABLE 4,800 SF



SEC E. 2nd St. & Ravenna Dr., Long Beach, CA 90803

Annika Riphagen

(562) 431-8734 x-114
ariphagen@pacret.com
DRE License #: 01734521

Mike Jensen

(562) 431-8734 x-110
jensen@pacret.com
DRE License #: 00885730

911 Studebaker Road
Suite 205
Long Beach, CA 90815

www.pacret.com

Creating
Real Estate
Value

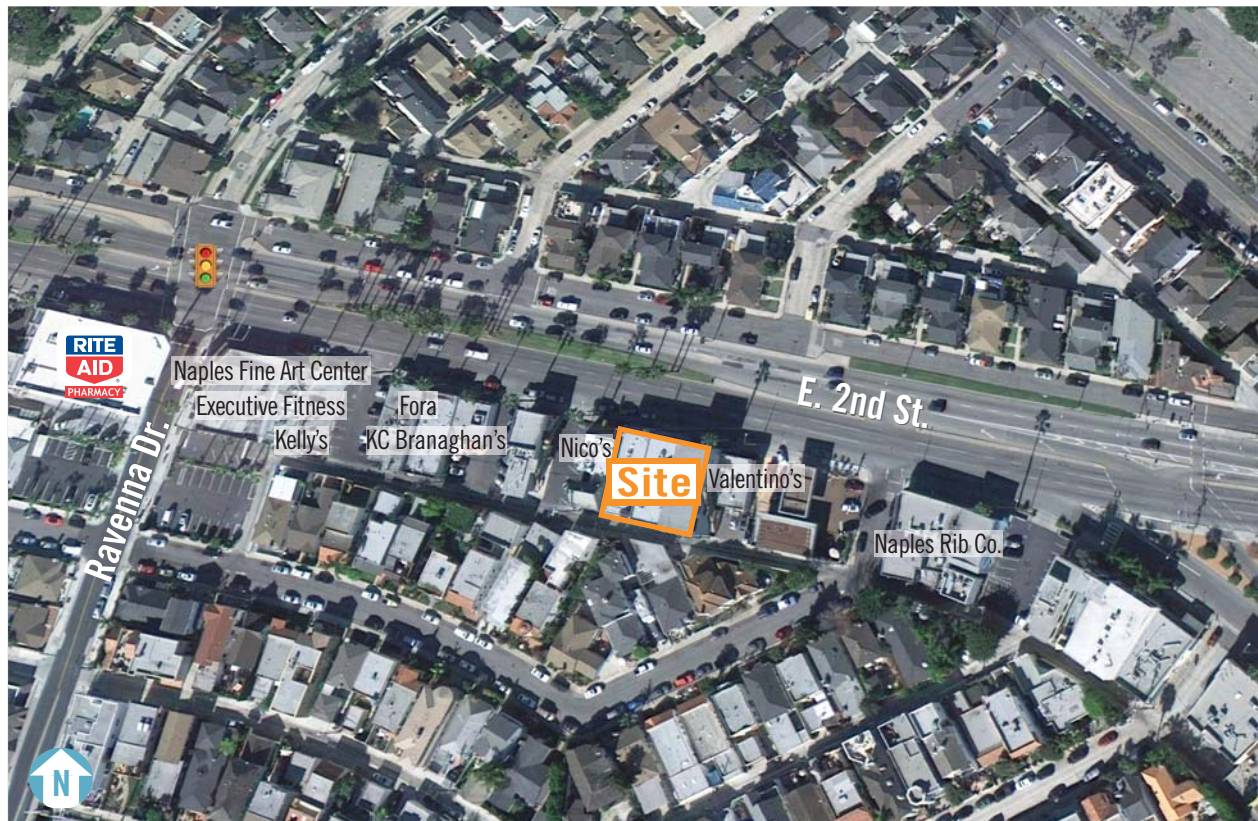

Demographics

(2010 Est.)	0.5 Mile	1 Mile	2 Mile	3 Mile
Population	5,765	17,511	55,728	144,305
Households	3,054	9,704	29,007	68,435
Avg. HH Income	\$162,607	\$139,107	\$115,855	\$85,431
Med. HH Income	\$108,187	\$97,226	\$84,775	\$62,067
Daytime Population	3,759	13,983	40,044	100,120

Traffic Counts

E. 2nd St.	40,800	Source: City of Long Beach
Ravenna Dr.	N/A	

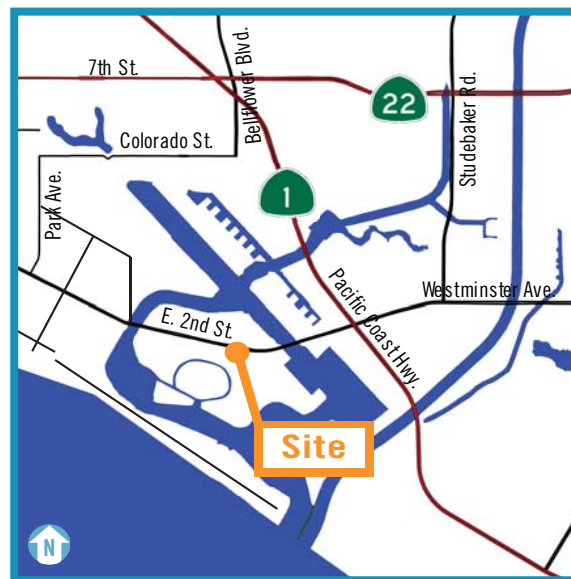

Scan with your
mobile device



The information above has been obtained from sources believed reliable. While we do not doubt its accuracy, we have not verified it and make no guarantee, warranty or representation. It is your responsibility to independently confirm its accuracy and completeness.

AVAILABLE 4,800 SF



PACIFIC RETAIL PARTNERS

SEC E. 2nd St. & Ravenna Dr., Long Beach, CA 90803

Annika Riphagen

(562) 431-8734 x-114

ariphagen@pacret.com

DRE License #: 01734521

Mike Jensen

(562) 431-8734 x-110

jensen@pacret.com

DRE License #: 00885730

911 Studebaker Road
Suite 205
Long Beach, CA 90815

www.pacret.com

Creating
Real Estate
Value

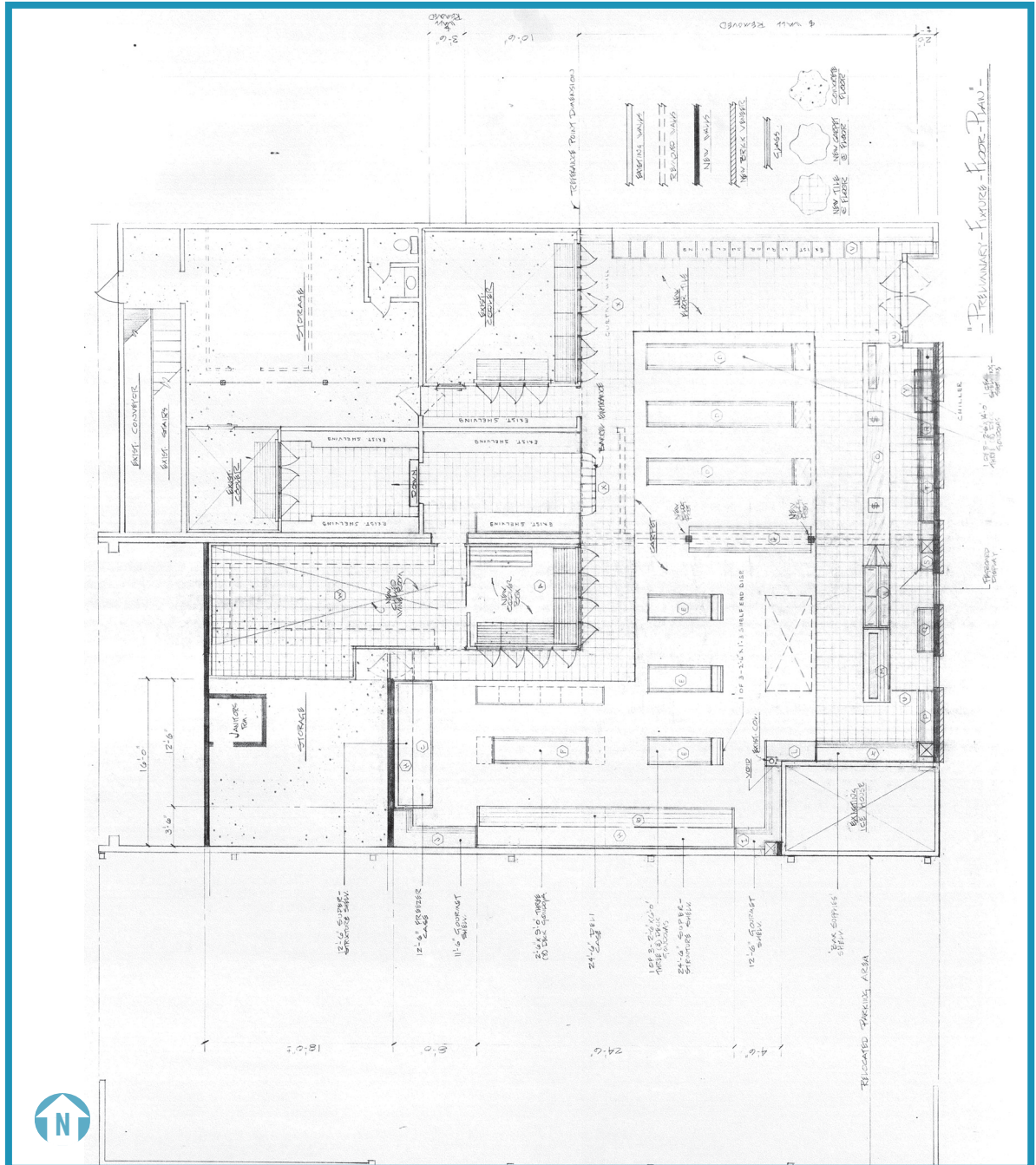

Property Highlights

- Street Address: 5764-5768 E. 2nd St., Naples
- Rare 6 dedicated parking spaces
- Former Morry's of Naples - recently renovated, fully fixtured liquor store and wine tasting room

The information above has been obtained from sources believed reliable. While we do not doubt its accuracy, we have not verified it and make no guarantee, warranty or representation. It is your responsibility to independently confirm its accuracy and completeness.