

AVAILABLE ± 2,711 SF



NWC Woodruff Ave. & South St., Lakewood, CA 90713

Annika Riphagen

(562) 431-8734 x-114
ariphagen@pacret.com
DRE License #: 01734521

911 Studebaker Road
Suite 205
Long Beach, CA 90815

www.pacret.com

Creating
Real Estate
Value



Demographics

(2010 Est.)	0.5 Mile	1 Mile	2 Mile	3 Mile
Population	5,409	27,202	103,346	248,237
Households	1,942	9,620	36,013	81,002
Avg. HH Income	\$88,052	\$86,083	\$78,442	\$74,867
Med. HH Income	\$78,262	\$77,341	\$65,977	\$61,728
Daytime Population	3,997	17,984	85,837	203,968

Traffic Counts

Woodruff Ave.	22,206	Source: CoStar Group Inc.
South St.	29,762	

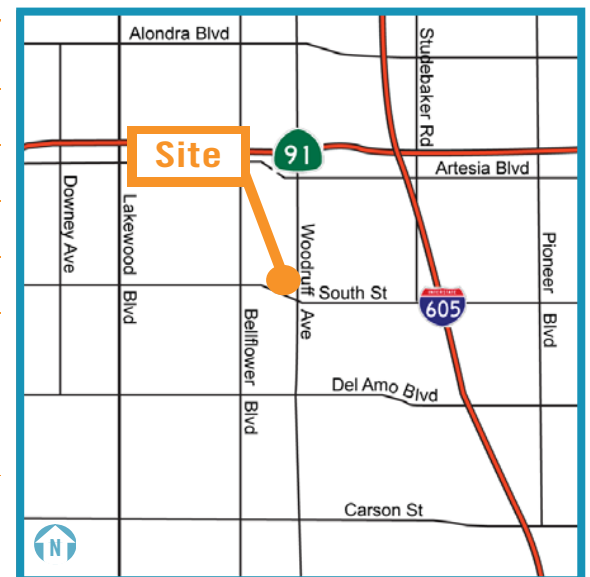

Scan with your
mobile device



The information above has been obtained from sources believed reliable. While we do not doubt its accuracy, we have not verified it and make no guarantee, warranty or representation. It is your responsibility to independently confirm its accuracy and completeness.

AVAILABLE ± 2,711 SF



PACIFIC RETAIL PARTNERS

NWC Woodruff Ave. & South St., Lakewood, CA 90713

Annika Riphagen

(562) 431-8734 x-114

ariphagen@pacret.com

DRE License #: 01734521

911 Studebaker Road
Suite 205
Long Beach, CA 90815

www.pacret.com

Creating
Real Estate
Value

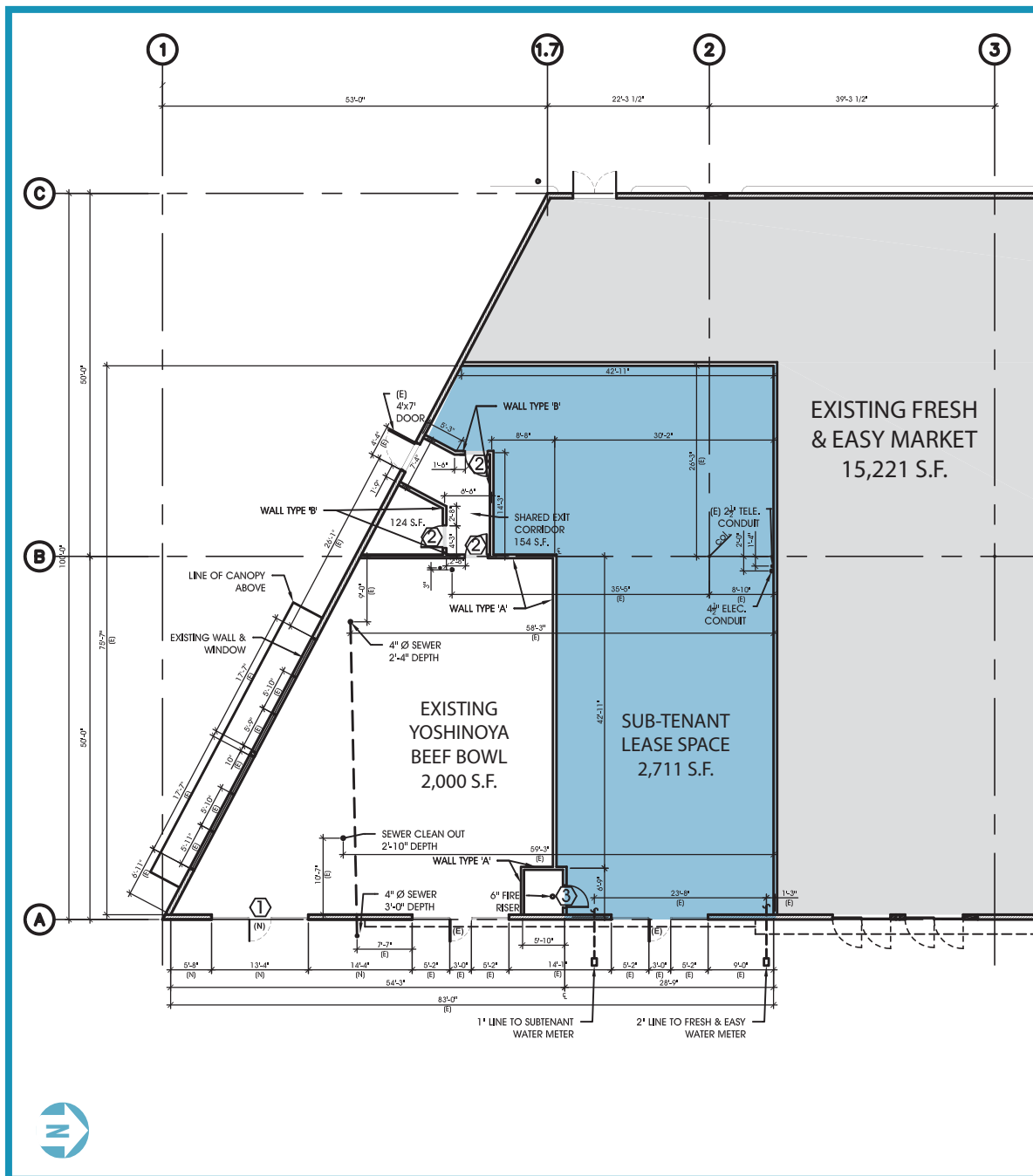

Property Tenants



Neighborhood Market



The information above has been obtained from sources believed reliable. While we do not doubt its accuracy, we have not verified it and make no guarantee, warranty or representation. It is your responsibility to independently confirm its accuracy and completeness.