

AVAILABLE 40,000 SF



PACIFIC RETAIL PARTNERS

NWC South St. & Carmenita Rd., Cerritos, CA 90703

Annika Riphagen

(562) 431-8734 x-114
ariphagen@pacret.com
DRE License #: 01734521

Mike Jensen

(562) 431-8734 x-110
jensen@pacret.com
DRE License #: 00885730

911 Studebaker Road
Suite 205
Long Beach, CA 90815

www.pacret.com

Creating
Real Estate
Value



Demographics

(2010 Est.)	0.5 Mile	1 Mile	2 Mile	3 Mile
Population	7,992	26,928	90,352	220,845
Households	2,569	8,560	28,106	66,266
Avg. HH Income	\$114,942	\$112,841	\$98,365	\$84,031
Med. HH Income	\$94,027	\$92,590	\$82,405	\$67,884
Daytime Population	5,098	19,185	82,269	213,411

Traffic Counts

South St.	23,682	Source: CoStar Group Inc.
Carmenita Rd.	23,300	

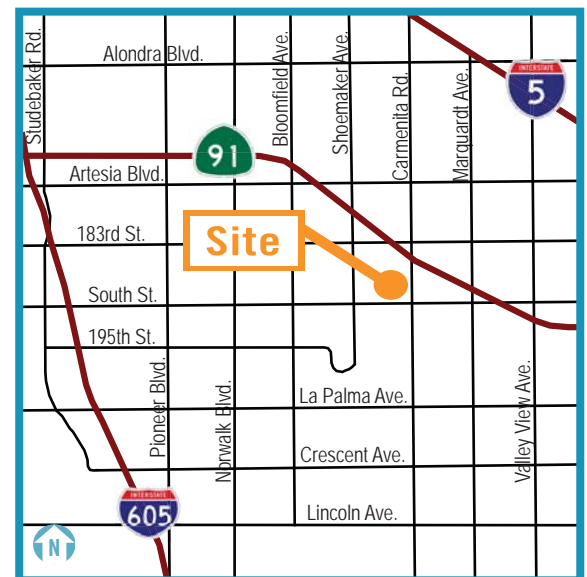

Scan with your
mobile device



The information above has been obtained from sources believed reliable. While we do not doubt its accuracy, we have not verified it and make no guarantee, warranty or representation. It is your responsibility to independently confirm its accuracy and completeness.

AVAILABLE 40,000 SF



NWC South St. & Carmenita Rd., Cerritos, CA 90703

Annika Riphagen

(562) 431-8734 x-114
ariphagen@pacret.com
DRE License #: 01734521

Mike Jensen

(562) 431-8734 x-110
jensen@pacret.com
DRE License #: 00885730

911 Studebaker Road
Suite 205
Long Beach, CA 90815

www.pacret.com

Creating
Real Estate
Value

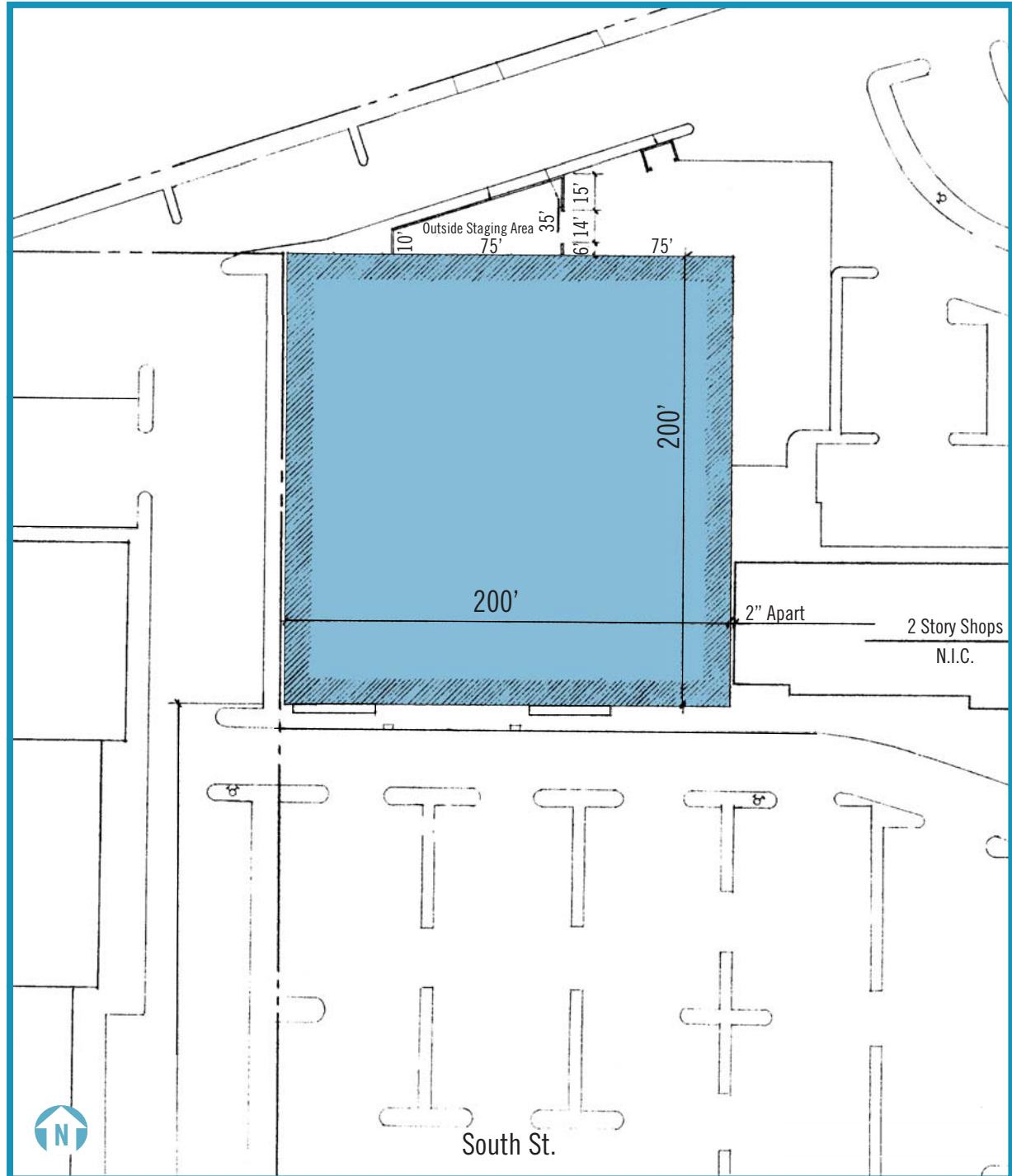

Property Highlights

- Opportunity in Ralphs and CVS anchored shopping center

The information above has been obtained from sources believed reliable. While we do not doubt its accuracy, we have not verified it and make no guarantee, warranty or representation. It is your responsibility to independently confirm its accuracy and completeness.