

AVAILABLE 17,142 SF



NEC Eagle Rock Blvd. & Ave. 42, Glassell Park CA 90065

Annika Riphagen

(562) 431-8734 x-114
ariphagen@pacret.com
DRE License #: 01734521

911 Studebaker Road
Suite 205
Long Beach, CA 90815

www.pacret.com

Creating
Real Estate
Value

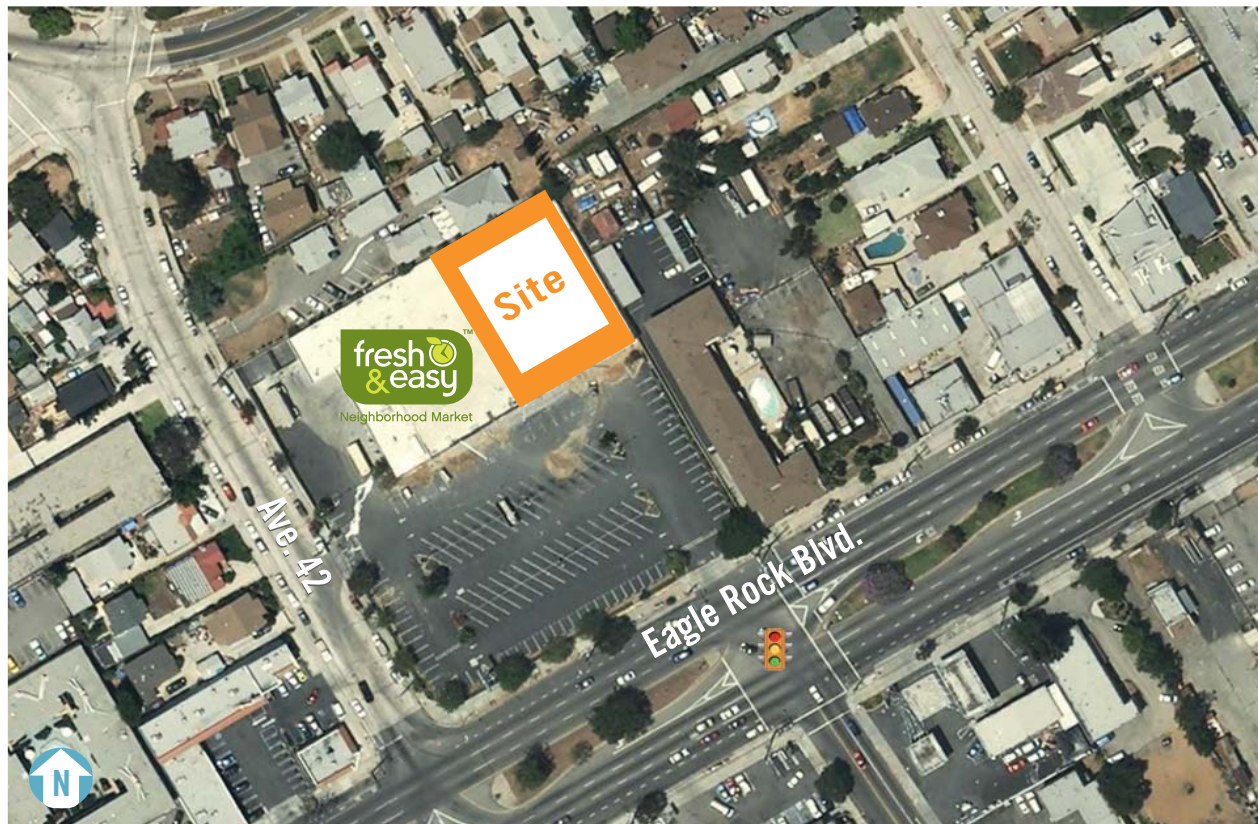

Demographics

(2010 Est.)	0.5 Mile	1 Mile	2 Mile	3 Mile
Population	8,041	34,385	149,456	287,761
Households	2,920	11,159	47,755	99,128
Avg. HH Income	\$68,209	\$66,849	\$56,651	\$63,022
Med. HH Income	\$61,038	\$56,227	\$41,554	\$45,356
Daytime Population	5,746	22,255	113,230	257,093

Traffic Counts

Eagle Rock Blvd.	55,776	Source: CoStar Group Inc.
York Blvd.	24,934	

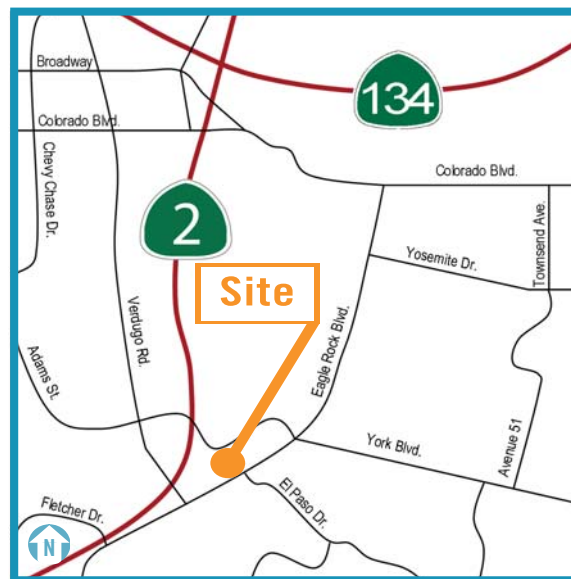

Scan with your
mobile device



The information above has been obtained from sources believed reliable. While we do not doubt its accuracy, we have not verified it and make no guarantee, warranty or representation. It is your responsibility to independently confirm its accuracy and completeness.

AVAILABLE 17,142 SF



PACIFIC RETAIL PARTNERS

NEC Eagle Rock Blvd. & Ave. 42, Glassell Park CA 90065

Annika Riphagen

(562) 431-8734 x-114

ariphagen@pacret.com

DRE License #: 01734521

911 Studebaker Road
Suite 205
Long Beach, CA 90815

www.pacret.com

Creating
Real Estate
Value

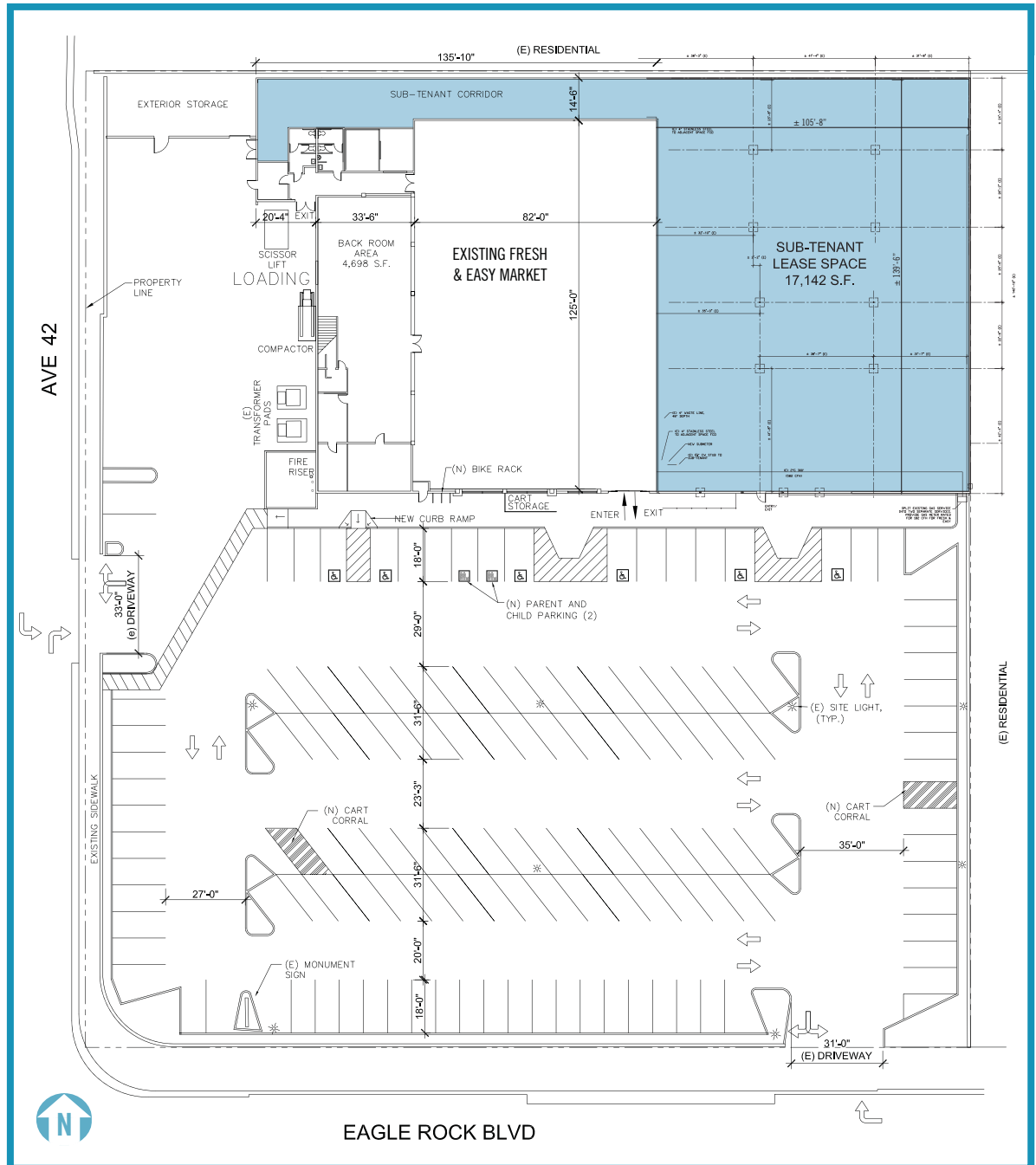

EAGLE ROCK BLVD

Property Highlights

- Signalized intersection
- One of Fresh & Easy's top performing stores

The information above has been obtained from sources believed reliable. While we do not doubt its accuracy, we have not verified it and make no guarantee, warranty or representation. It is your responsibility to independently confirm its accuracy and completeness.

