

AVAILABLE ± 2,711 SF



NWC Woodruff Ave. & South St., Lakewood, CA 90713



Annika Riphagen
(562) 431-8734 x-114
ariphagen@pacret.com

Brendan Cavanaugh
(562) 431-8734 x-123
bcavanaugh@pacret.com

911 Studebaker Road
Suite 205
Long Beach, CA 90815

www.pacret.com

Creating
Real Estate
Value

Demographics

(2008 Est.)	.5 Mile	1 Mile	2 Mile	3 Mile
Population	5,774	27,984	105,422	253,050
Households	1,958	9,343	34,570	77,537
Avg. HH Income	\$89,379	\$81,371	\$75,327	\$73,566
Med. HH Income	\$73,107	\$72,143	\$62,800	\$60,550
Daytime Population	1,360	5,601	40,490	83,312

Traffic Counts

	.5 Mile	
Woodruff Ave.	57,523	Source: City of Lakewood
South St.	42,502	

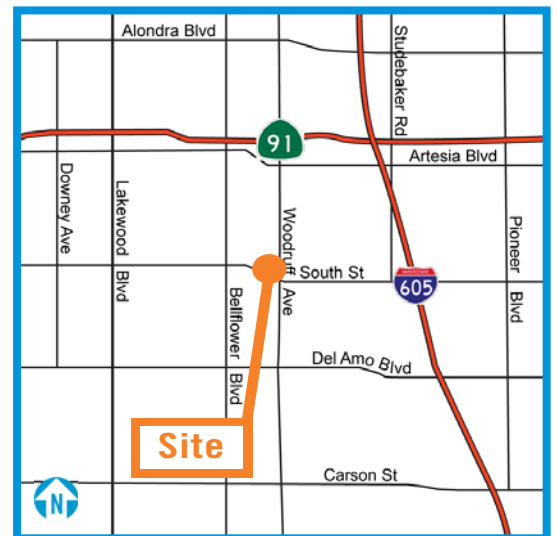

The information above has been obtained from sources believed reliable. While we do not doubt its accuracy, we have not verified it and make no guarantee, warranty or representation. It is your responsibility to independently confirm its accuracy and completeness.

AVAILABLE ± 2,711 SF



NWC Woodruff Ave. & South St., Lakewood, CA 90713

Annika Riphagen
(562) 431-8734 x-114
ariphagen@pacret.com

Brendan Cavanaugh
(562) 431-8734 x-123
bcavanaugh@pacret.com

911 Studebaker Road
Suite 205
Long Beach, CA 90815

www.pacret.com

Creating
Real Estate
Value

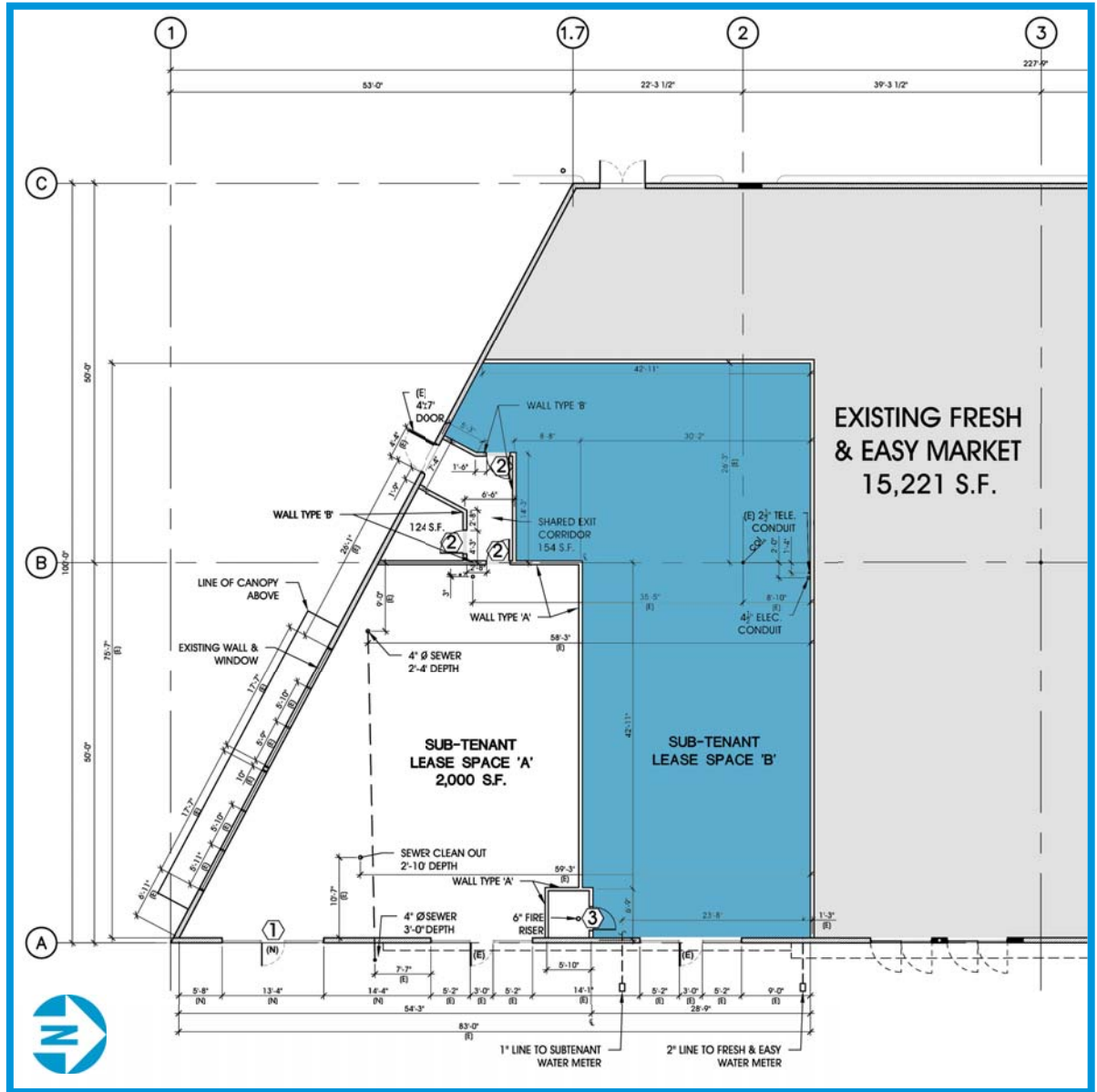

Property Tenants



The information above has been obtained from sources believed reliable. While we do not doubt its accuracy, we have not verified it and make no guarantee, warranty or representation. It is your responsibility to independently confirm its accuracy and completeness.